

# Product Specification Guide-Table of Contents

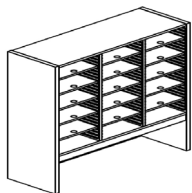

## Sort Modules

2-3

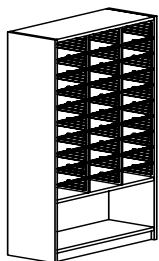

## Freestanding Sort Modules

4-5

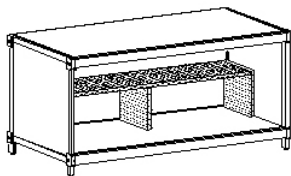

## Aluminum Framed Consoles

6-7

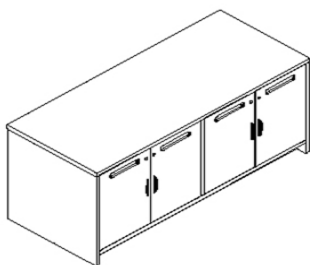

## All-Laminate Consoles

8-9

## Color Reference Chart

10

## Product Specification Sheet - Sort Module

### Specifications

- Sort shelves readjust along full depth rigid PVC plastic channel guides that allow for easy shelf adjustment.
- Adjustable Plastic Shelving: Constructed of 1/8" thick .90 gauge polyethylene with memory retention. Shelves are adjustable on 1" increments that provide full depth support. Shelves are supported front and rear with aluminum index track and clear index cover and are rated for capacity loads up to 35 lbs.
- Adjustable Wood Shelving: Constructed of 5/8" thick matching thermally fused melamine with 1.5mm PVC edge banding. Shelves are adjustable on 1" increments and have optional self-applying index strips. Shelves are rated for capacity loads up to 50 lbs.
- Sort modules come in 1 to 6 column configurations. Modules up to 30" high feature 5 re-adjustable shelves providing 6 openings. Modules over 30" high feature 7 re-adjustable shelves providing 8 openings. Additional shelves can be purchased separately or in packs of five.
- Sort modules are available in standard closed back, open back for pass through operations and plexiglass back for additional working light.
- Sort modules available standard, legal or oversize configurations for standard 8<sup>1/2</sup> x 11 size documents, legal size documents and oversize documents like newspapers and periodicals.
  - Sort Module Shelf Inside Dimensions:
  - Standard size shelf inside dimensions: 10<sup>1/8</sup>" width x 12" depth
  - Legal size shelf inside dimensions: 10<sup>1/8</sup>" width x 16" depth
  - Oversize shelf inside dimensions: 12<sup>1/8</sup>" width x 16" depth

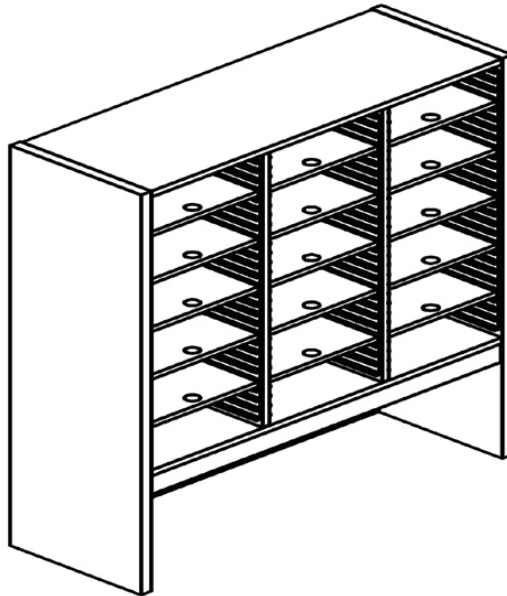

### Construction

- Side Panels: Constructed of 1" thick industrial grade 40-50 lb. sub-straight, double-faced melamine. Framed by matching 1.5mm PVC edge banding.
- Top and Bottom Panels: Constructed of 5/8" thick industrial grade 40-50 lb. sub-straight, double-faced melamine. Framed by matching 1.5mm PVC edge banding.
- Back Panel: Constructed of 5/8" thick industrial grade 40-50 lb. sub-straight, double-faced melamine.
- Vertical Dividers: Constructed of 5/8" thick industrial grade 40-50 lb. sub-straight, double-faced melamine. Framed by matching 1.5mm PVC edge banding.
- Sort modules are shipped fully assembled.

### Assembly

- Sort modules are assembled using Hafele mini-fix cam hidden fastener system with metal-to-metal connection points. Parts are drilled using a 32mm hole drilling via computer controlled point-to-point machines for insured uniformity and consistency.
- Sort module affixes to Hamilton Sorter consoles with Hafele mini-fix cam lock so that depth of sort module can be readjusted for varying user requirements.

### **Optional Features**

- Plexiglass doors in clear or smoked plexiglass with available locking feature.
- Optional 3", 6", 12" or 18" risers for access to additional console worksurface.
- Optional display boards for locator lists.
- Shelf dividers for partitioning of polyethylene shelving.
- Module drawers for organizing worksurface items such as staplers, paper clips and other loose items.

### **Model Number Logic**

Ex. O6-48PBE12-007-007-007

- O = Oversize, L = Legal Size, S = Standard Size shelves
- 6 = Number of sorting columns
- 48 = Overall height of module (add height of optional risers if one is specified)
- PB = Plexiglass Back, OB = Open Back, No letters signifies standard closed back module
- E = Selects an optional riser
- 12 = Signifies the height of the optional riser, options include 03 (3"), 06 (6"), 12 (12") & 18 (18")
- 007 = Signifies selected module laminate color, choose from 10 standard melamine colors
- 007 = Signifies selected edge banding color, matches each standard melamine color
- 007 = Shelf and Shelf support color, choose from Black (007) Grey (002) or Brown (004)

## Product Specification Sheet - Freestanding Sort Module

### Specifications

- Sort shelves readjust along full depth rigid PVC plastic channel guides that allow for easy shelf adjustment.
- Adjustable Plastic Shelving: Constructed of 1/8" thick .90 gauge polyethylene with memory retention. Shelves are adjustable on 1" increments that provide full depth support. Shelves are supported front and rear with aluminum index track and clear index cover and are rated for capacity loads up to 35 lbs.
- Adjustable Wood Shelving: Constructed of 5/8" thick matching thermally fused melamine with 1.5mm PVC edge banding. Shelves are adjustable on 1" increments and have optional self-applying index strips. Shelves are rated for capacity loads up to 50 lbs.
- Freestanding Sort Modules (FSM) come in 3 or 4 column configurations. FSM's with bottom storage areas and sliding reference shelves feature 7 adjustable shelves providing 8 openings per column. All other FSM's feature 12 shelves per column providing 13 openings per column. Additional shelves can be purchased separately or in packs of five.
- FSM's are available in widths of 36<sup>7/16"</sup>, 42<sup>7/16"</sup>, 48<sup>1/8"</sup>, or 56<sup>1/8"</sup> and heights of 48", 60", 66", 72" and 76".
- FSM's are with optional bottom storage area with or without sliding doors, pull out reference shelf or 12" kickplate.
- FSM's are available in standard, legal or oversize configurations for standard 8<sup>1/2</sup> x 11 size documents, legal size documents and oversize documents like newspapers and periodicals.
- FSM Shelf Inside Dimensions:
  - Standard size shelf inside dimensions: 10<sup>1/8"</sup> width x 12" depth
  - Legal size shelf inside dimensions: 10<sup>1/8"</sup> width x 16" depth
  - Oversize shelf inside dimensions: 12<sup>1/8"</sup> width x 16" depth
- Bottom storage are for Freestanding Modules:
  - FSM w/ Bottom Storage Inside Clearance

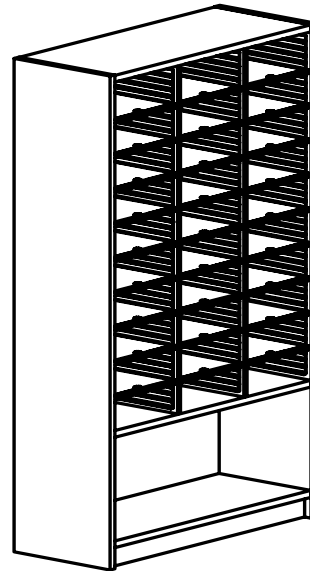

Configuration	Depth	Height
Standard Size	12"	15"
Legal/Oversize	16"	15"

- FSM w/ Sliding Reference Shelf Inside Clearance

Configuration	Depth	Height
Standard Size	12"	21 <sup>3/8"</sup>
Legal/Oversize	16"	21 <sup>3/8"</sup>

### Construction

- Side Panels: Constructed of 1" thick industrial grade 40-50 lb. sub-straight, double-faced melamine. Framed by matching 1.5mm PVC edge banding.
- Top and Bottom Panels: Constructed of 5/8" thick industrial grade 40-50 lb. sub-straight, double-faced melamine. Framed by matching 1.5mm PVC edge banding.
- Back Panel: Constructed of 5/8" thick industrial grade 40-50 lb. sub-straight, double-faced melamine.
- Vertical Dividers: Constructed of 5/8" thick industrial grade 40-50 lb. sub-straight, double-faced melamine. Framed by matching 1.5mm PVC edge banding.
- FSM's are shipped fully assembled.

### **Assembly**

- FSM's are assembled using Hafele mini-fix cam hidden fastener system with metal-to-metal connection points. Parts are drilled using a 32mm hole drilling via computer controlled point-to-point machines for insured uniformity and consistency.

### **Optional Features**

- Optional full height doors available as well as bottom storage are, bottom storage with sliding doors or FSM with pull out reference shelf for tub sorting.
- Optional display boards for locator lists.
- Shelf dividers for partitioning of polyethylene shelving.
- Module drawers for organizing worksurface items such as staplers, paper clips and other loose items.

### **Model Number Logic**

Ex. FSM421672SBSR-007-007-007

- FSM = Freestanding Sort Module
- 42 = Width of FSM
- 16 = Depth of FSM
- 72 = Height of FSM
- S = Configurations, S = Standard, L = Legal and O = Oversize
- B = Bottom storage area
- SR = Sliding reference shelf
- 007 = Signifies selected module laminate color, choose from 10 standard melamine colors
- 007 = Signifies selected edge banding color, matches each standard melamine color
- 007 = Shelf and Shelf support color, choose from Black (007) Grey (002) or Brown (004)

## Product Specification Sheet – Aluminum Framed Console

### Specifications

- All consoles come equipped with adjustable leveling guides to insure stable machine support on uneven floor environments.
- Aluminum framed consoles are available in the following configurations:
  - **Basic** (CT)- featuring open frame.
  - **Half-Shelf** (CH)- featuring a 15” or 18” deep half-shelf.
  - **Full-Shelf** (CS)- featuring a 30” or 36” deep full-shelf.
  - **Cabinet** (CC)- featuring a full-shelf and sliding doors
  - **Center Mount Modesty** (CX)- featuring a center mounted modesty panel designed to support additional weight.
- Consoles come in standard widths of 24” to 84”, depths of 24” to 36” and heights of 30”, 36” & 42”..
- Toe clearance options for consoles are available in 3” and 9”. Modifications are available to width, depth, height and clearance.
- All consoles are rated to support up to 750 lbs. Center Mount Modesty Consoles are rated to support up to 1,000 lbs.

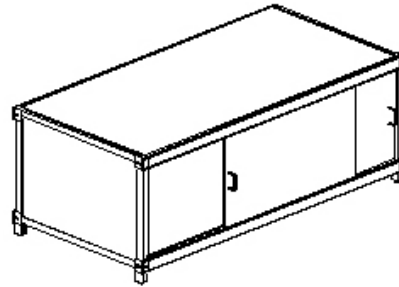

### Specialty Console Specifications

- All consoles come equipped with adjustable leveling guides to insure stable machine support on uneven floor environments.
- Specialty Consoles are available in the following configurations:
  - **Manifest Shipping Consoles** (MAN)- features a cabinet console with three grommets sold with a platform and articulating keyboard for supporting technology.
  - **Crank Adjustable Consoles** (CTxxxxxxADJ)- feature a Basic Console fitted with a crank adjustment that elevates the height of the table from 24” to 36”. Rated to support up to XX lbs.
  - **Electric Adjustable Consoles** (CTxxxxxxELE)- feature a Basic Console fitted with an electrical adjustment that elevates the height of the table from 24” to 36”. Rated to support up to XX lbs.
  - **Adjustable Scale Consoles** (SU)- features a Basic Console with a 6” drop down worksurface to make for more ergonomic mail weighing and metering. Worksurface can be readjusted up to 6” for various scale heights.
  - **Console with Rollers** (CR)- Basic Console fitted with 22” wide steel ball bearing rollers for package shuttle into Manifest Shipping Stations.
  - **Shuttle Sort Systems** (SS)- Includes a CT console with added support and mounted track, also includes three sort modules, two rear and one front, for additional sorting capacity.

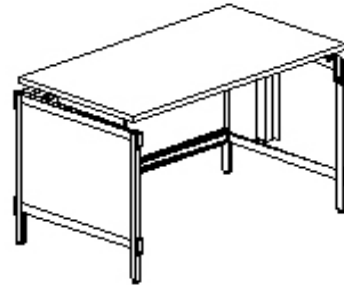

### Construction

- Leg units and supports are constructed of custom designed multi-cavity aluminum extrusions with a satin anodized finish and inlaid feature strips, optional aluminum finishes include silver-vein, copper-vein and black powdercoat.
- Leg panels are constructed of 5/8” industrial grade, 40-50 lb. substrate double-faced melamine slotted into custom designed aluminum extrusions.
- Modesty panels are constructed of 3/8” industrial grade, 40-50 lb. substrate double-faced melamine.
- Undertable shelves are constructed of 5/8” industrial grade, 40-50 lb. substrate double-faced melamine framed with impact resistant 1.5mm PVC edgebanding.

- Sliding doors for undertable cabinets are constructed of 3/8" industrial grade, 40-50 lb. substrate double-faced melamine slotted into custom designed aluminum extrusions fitted with a nickel plated zinc alloy bow handle. Optional plunger locks available.
- Worksurfaces are constructed of 11/16" thick high-pressure laminate (HPL) with industrial grade 40-50 lb. substrate, backed with a .027 phenolic backer.

### **Assembly**

- Units are shipped knocked down and are assembled with 1/4"-20 machine screws with allen-type head and Phillips head self tapping screws.

### **Optional Features**

- Optional console wheels include straight wheel, swivel wheel and swivel wheel with brake.
- Available dump rims frame console work surface and catch material dumped for primary sorts.
- Vertical partitions available for organizing shipping materials such as envelopes and boxes.
- Optional worksurfaces like ABS and stainless steel available.
- Cable management options include cable raceway, pop-up power centers and cable cutouts.
- Tasking accessories include optional articulating keyboard and keyboard drawer.
- Undertable storage options include suspended pedestals, caster pedestals and pencil drawers.
- Anti-fatigue mats available to place in front of consoles to improve workplace ergonomics.
- Available with full or half-depth intermediate shelves for CS and CC consoles.

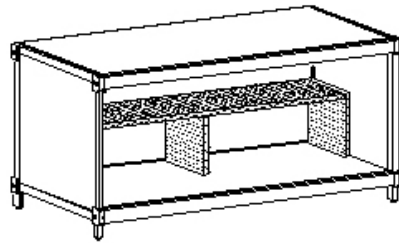

### **Model Number Logic**

Ex. CC603030BRW-002-002-002

- CC = Cabinet Console, also available in Basic Console (CT), Half-Shelf Console (CH), Full-Shelf Console (CS) and Center Modesty Console (CX). Specialty consoles also available.
- 60 = 60" wide. Available in widths of 24" to 84".
- 30 = 30" deep. Available in depths of 30" and 36".
- 30 = 30" high. Available in heights of 30", 36" and 42".
- B = 3" clearance, also available in 9" clearance.
- R = Slotted grooves in aluminum extrusion for dump rims, order dump rims separately
- W = Console legs fitted for wheels, order wheel type separately
- 002 = Signifies selected console worksurface laminate color; choose from 15 high-pressure laminate colors.
- 002 = Signifies selected console base laminate color, choose from 10 standard melamine colors.
- 002 = Signifies selected front laminate color for sliding cabinet doors, available on CC consoles only.

## Product Specification Sheet – All-Laminate Consoles

### Specifications

- Components are all-laminate construction with no aluminum extrusions.
- Consoles- features standard consoles (EMT), corner consoles (EMT), counter consoles (EC) and credenza consoles (EMC).
- Standard consoles are available with optional full depth shelf (EMS) as well as optional half leg or full modesty panel.
- Consoles and credenzas feature widths specifically sized to support sort modules in addition to overhead units.
- Consoles feature widths from 24" to 72", depths of 24" and 30" and heights of 30" (42" for Counter Console).
- Credenza consoles feature hinged doors and one adjustable shelf per storage section. Credenzas up to 48" wide feature one storage section and two hinged doors, credenzas wider than 48" feature two storage sections and four hinged doors. Optional sliding doors are available on consoles with full depth shelf.
- Credenzas feature a recessed 3" kickplate and black elliptical handles.
- All components are available in 10 standard color configurations. Consoles and credenzas feature 10 standard chassis colors and 5 worksurface only colors.

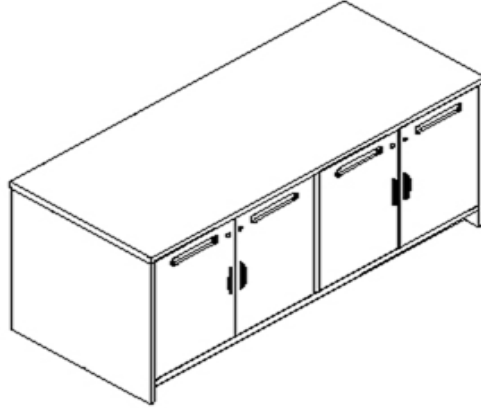

### Construction

- Console/Credenza Side Panels: Constructed of 1" thick industrial grade 40-50 lb. sub-straight, double-faced melamine. Framed by matching 1.5mm PVC edge banding.
- Console/Credenza Back Panel: Constructed of 1" thick industrial grade 40-50 lb. sub-straight, double-faced melamine.
- Console/Credenza Worksurface is constructed of 1<sup>1/16</sup>" thick high-pressure laminate (HPL) with industrial grade 40-50 lb. sub-straight, backed with a .027 phenolic backer.
- All panels are connected with Hafele mini-fix cam hidden fastener system with metal-to-metal connection points. Parts are drilled using a 32mm hole drilling via computer controlled point-to-point machines for insured uniformity and consistency.
- Consoles are shipped knocked down. Console credenzas are shipped fully assembled.

### Assembly

- Sort modules and overhead units adhere to credenzas and consoles with double-faced adhesive tape.

### Accessory Components

- Articulating keyboard trays available for consoles.
- Optional pre-drilled mail slots with plastic mail slot inserts available on credenzas.
- Electrical accessories include retractable power centers, 6-outlet strips and cable raceways.

## **Model Number Logic**

Ex. EMC603030SL-025-002-002

- EMC = credenza console, (EMS) console with full shelf, (EMT) standard console.
- 60 = 60" wide
- 30 = 30" deep
- 30 = 30" high
- SL = Selects optional pre-drilled mail slots with plastic slot inserts.
- 025 = Signifies selected console worksurface color; choose from 15 high-pressure laminate colors.
- 002 = Signifies selected worksurface edgebanding to coordinate with worksurface color.
- 002 = Signifies selected console base color, choose from 10 standard melamine colors.
- 002 = Signifies selected credenza door color; choose from 10 standard melamine colors. Available for credenzas only.

## Color Reference Chart

As of 2/1/2002

These laminate colors are available at standard price. Other colors available on request, by quote. The shelf color shown on this chart will be furnished unless another color is specified. Shelf and shelf supports are available in Black, Brown and Grey only.

### For 5 Day Priority Shipments Bases, Verticals and Worksurfaces

Color Name & Number		Shelf & Shelf Support		Work Surface	Base & Verticals	Edge Banding	Brand Name & Number
Natural Almond	050	Brown	004	•	•	•	Panval 920
Dove Grey	002	Gray	002	•	•	•	Wilsonart D92-60
Ingot Grey	006	Gray	002	•	•	•	Pionite SG211-S
Graphite Nebula	030	Black	007	•	•	•	Wilsonart 4623-60

### Designer Worksurfaces

Grey Glace	025			•		•	Wilsonart 4142-60
Beige Nebula	087			•		•	Wilsonart 4624-60
Erin Grey	022			•			Wilsonart 4306-90

### For Regularly Scheduled Shipments Bases, Verticals and Worksurfaces

Antique White	013	Brown	004	•	•	•	Wilsonart 1572-60
Natural Almond	050	Brown	004	•	•	•	Panval 920
Taupe	015	Brown	004	•	•	•	Pionite ST606-S
Fashion Grey	035	Grey	002	•	•	•	Wilsonart D381-60
Dove Grey	002	Grey	002	•	•	•	Wilsonart D92-60
Ingot Grey	006	Grey	002	•	•	•	Pionite SG211-S
Black	007	Black	007	•	•	•	Wilsonart 1595-60
Graphite Nebula	030	Black	007	•	•	•	Wilsonart 4623-60
Crystal Sandstorm	038	Grey	002	•	•	•	Panval 702
Hard Rock Maple II	036	Black	007	•	•	•	Wilsonart 10776-60

### Designer Worksurfaces

Grey Glace	025			•		•	Wilsonart 4142-60
White Nebula	086			•		•	Wilsonart 4621-60
Grey Nebula	088			•		•	Wilsonart 4622-60
Beige Nebula	087			•		•	Wilsonart 4624-60
Erin Grey	022			•			Wilsonart 4306-90